

## ESC II ELECTRONIC STABILITY CONTROL MOTOR

## ESC MOTOR

MOTOR



DRAWING

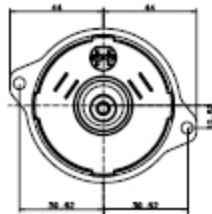
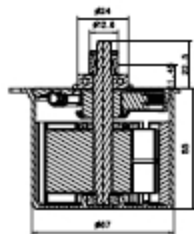

CLASS

SPECIFICATION

Input Voltage

13VDC

Rated Power

300 W

Rated Speed

3,600 RPM

Rated Torque

0.76 Nm

No load Speed

5,700 RPM